

AXIAL FORCE AND TORQUE (SWT) SERIES TRANSDUCERS

FEATURES

- Measure both Force and Torque
- High Accuracy Both Bridges
- Low Crosstalk
- Low Creep
- 5pt T/C Axial & CW/CCW Torsion Calibration
- Proprietary Modulus Compensated Strain Gages



SPECIFICATIONS

Model	SWT-10		SWT-10		SWT-20								
	Capacity	U.S. lbf./ in-lb	300/150, 500/250, 1K/500, Axial Force Bridge	Torque Bridge	2K/1K, 5K/2K Axial Force Bridge	Torque Bridge	10K/3K Axial Force Bridge	Torque Bridge					
PARAMETERS													
ACCURACY													
Nonlinearity, % Rated Output								+/-0.040	+/-0.070	+/-0.040	+/-0.070	+/-0.040	+/-0.070
Hysteresis, % Rated Output								+/-0.040	+/-0.050	+/-0.040	+/-0.050	+/-0.040	+/-0.050
Nonrepeatability, % Rated Output								+/-0.020	+/-0.050	+/-0.020	+/-0.050	+/-0.020	+/-0.050
Creep, % in 20 minutes								+/-0.025	+/-0.025	+/-0.025	+/-0.025	+/-0.025	+/-0.025
Zero Balance, % Rated Output								+/-2.0	+/-2.0	+/-2.0	+/-2.0	+/-2.0	+/-2.0
TEMPERATURE													
Range, Compensated, °F								+15 to +115	+15 to +115	+15 to +115	+15 to +115	+15 to +115	+15 to +115
Range, Compensated, °C								-10 to +45	-10 to +45	-10 to +45	-10 to +45	-10 to +45	-10 to +45
Range, Operating, °F								-65 to +200	-65 to +200	-65 to +200	-65 to +200	-65 to +200	-65 to +200
Range, Operating, °C								-55 to +90	-55 to +90	-55 to +90	-55 to +90	-55 to +90	-55 to +90
Effect on Sensitivity, % Rdg/ °F								+/-0.0008	+/-0.0008	+/-0.0008	+/-0.0008	+/-0.0008	+/-0.0008
Effect on Sensitivity, % Rdg/ °C								+/-0.0015	+/-0.0015	+/-0.0015	+/-0.0015	+/-0.0015	+/-0.0015
Effect on Zero, % Rated Output/ °F								+/-0.0015	+/-0.0015	+/-0.0015	+/-0.0015	+/-0.0015	+/-0.0015
Effect on Zero, % Rated Output/ °C								+/-0.0027	+/-0.0027	+/-0.0027	+/-0.0027	+/-0.0027	+/-0.0027
ELECTRICAL													
Rated Output, mV/V, Nominal								1.0	1.5	2.0	2.5	2.0	1.0
Excitation Voltage, VDC Maximum								20	20	20	20	20	20
Input Resistance, Ohms								350	350	350	350	350	350
Output Resistance, Ohms								350	350	350	350	350	350
Insulation Resistance, Megohm								5000	5000	5000	5000	5000	5000
Bayonet Connector								PT02E-10-6P (MS3112E-10-6P)					
MECHANICAL													
Safe Overload Range, % Capacity								+/-150	+/-150	+/-150	+/-150	+/-150	+/-150
Weight lb								4.15	4.15	10.6	10.6	32.19	32.19
Flexure Material								Aluminum			Steel		

AXIAL FORCE AND TORQUE (SWT) SERIES TRANSDUCERS

DIMENSIONS

Model	SWT-10	SWT-10	SWT-20
Capacity	300/150, 500/250, 1K/500,	2K/1K, 5K/2K	10K/3K
Dimensions	inch	inch	inch
1.	3.63	3.63	4.7
2.	R 2.53	R 2.53	R 3.5
3.	4.12 Dia.	4.12 Dia.	6.06 Dia
4.	3/8 -24 .66 Deep on 3.00 B.C.	3/8 -24 .66 Deep on 3.00 B.C.	3/8-24 .66 Deep on 3.00 B.C.
5.	.25 SF on 3.00 B.C.	.25 SF on 3.00 B.C.	.25 SF on 3.00 B.C.
6.	5/8-18 .95 Deep	5/8-18 .95 Deep	5/8-18 1.05 Deep

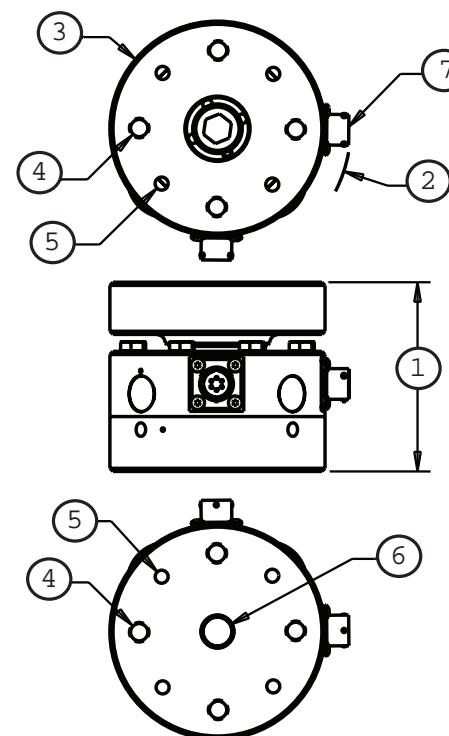

OPTIONS

- Additional bridges
- Output adjustment to standard
- Compression overload protection
- Integral cable
- Custom connectors
- Connector Protectors

ACCESSORIES

- Mating connector
- Loading fixtures
- Interconnect cable
- Shunt calibration resistor
- Instrumentation